

HALLOWEEN CAT

Both sides of the paper show. Choose a square of paper in colors suitable for a cat, e.g: black/white, black/brown, black/gray, black/orange, brown/ten, gray/white, etc. Fold the paper in half diagonally, white side in.

A
F
B

9
27
98

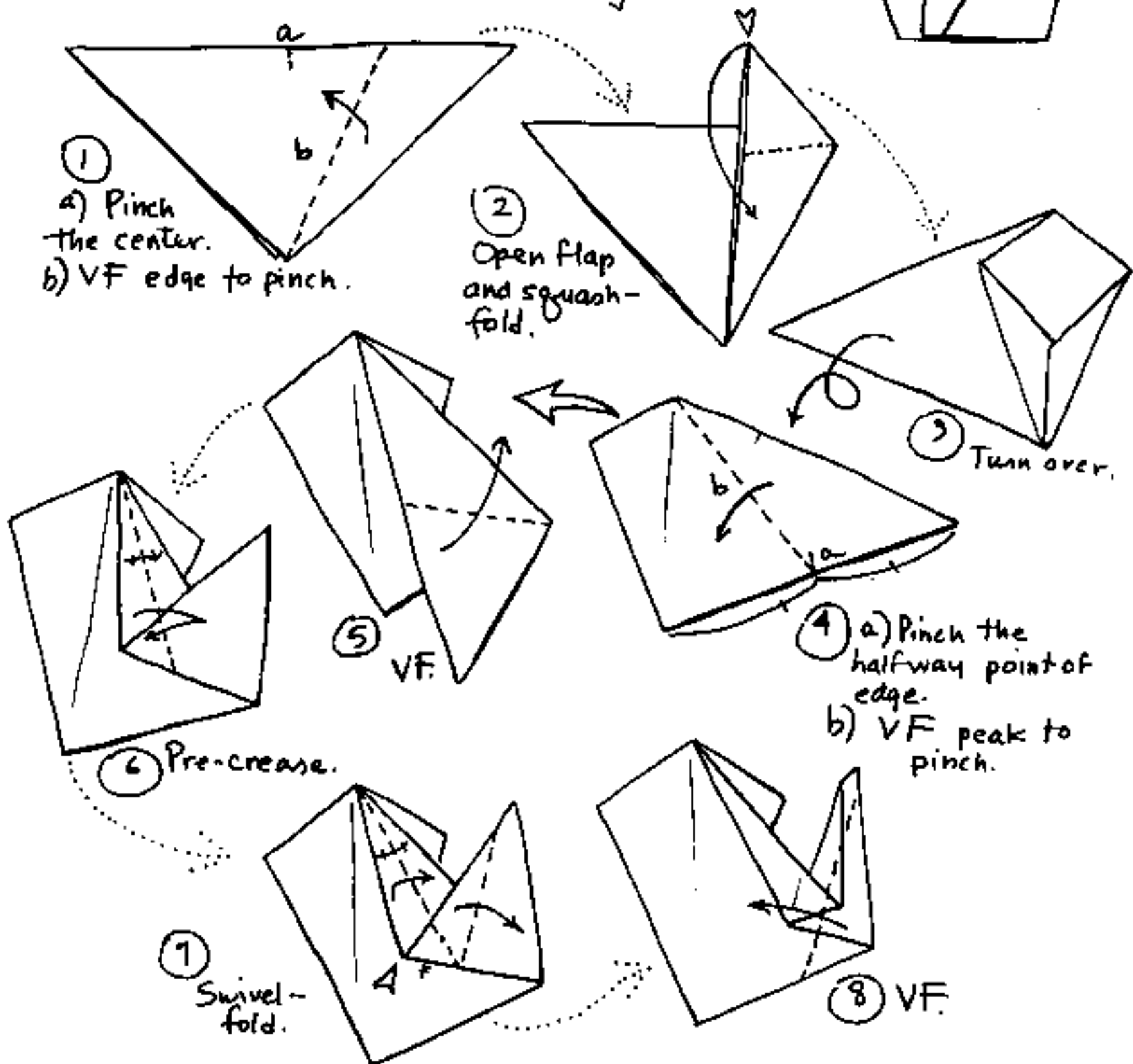
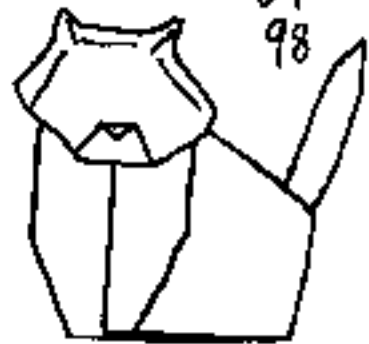

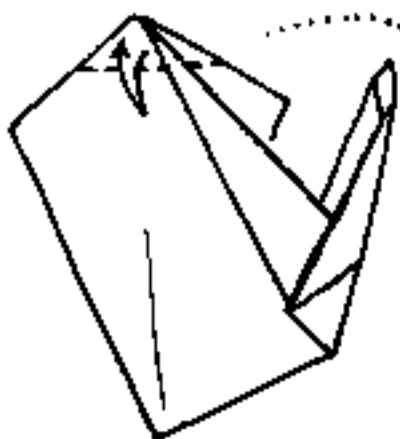

9) Pre-crease.

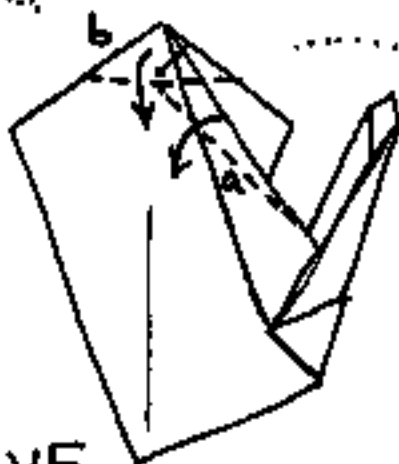

10) a) VF, while
b) Re-folding step 9.

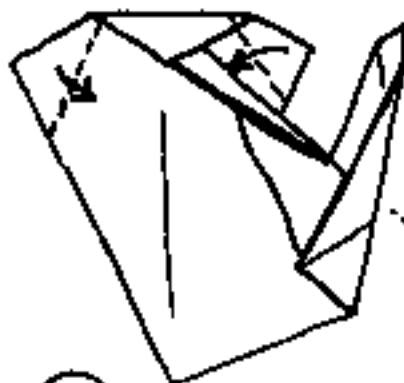

11) VF.

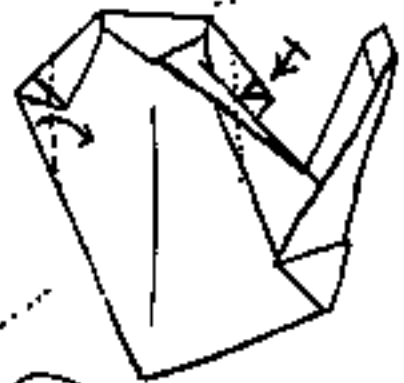

12) VF - note fold extends under near layer. Repeat on right, to match. (Lift tail out of the way.)

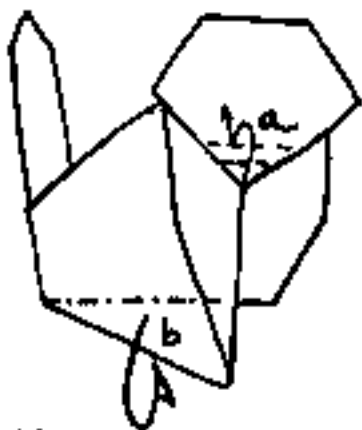

13) VF near layer + tuck over.

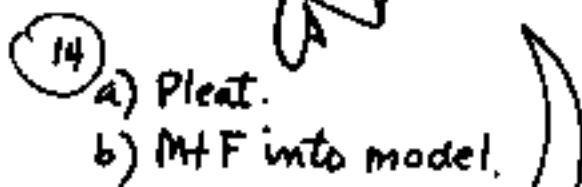

14) a) Pleat.
b) MF into model.



15) Shape head:
Mountain-fold on 3 sides while pinching ears.



16) Spread lower edges so cat can stand, or rather, sit up.

Variations - model can be made into a resting cat, or a cat standing, with back arched (has a cut for tail.)